

Product Data Sheet

Supporting Arm VarionPlus 195

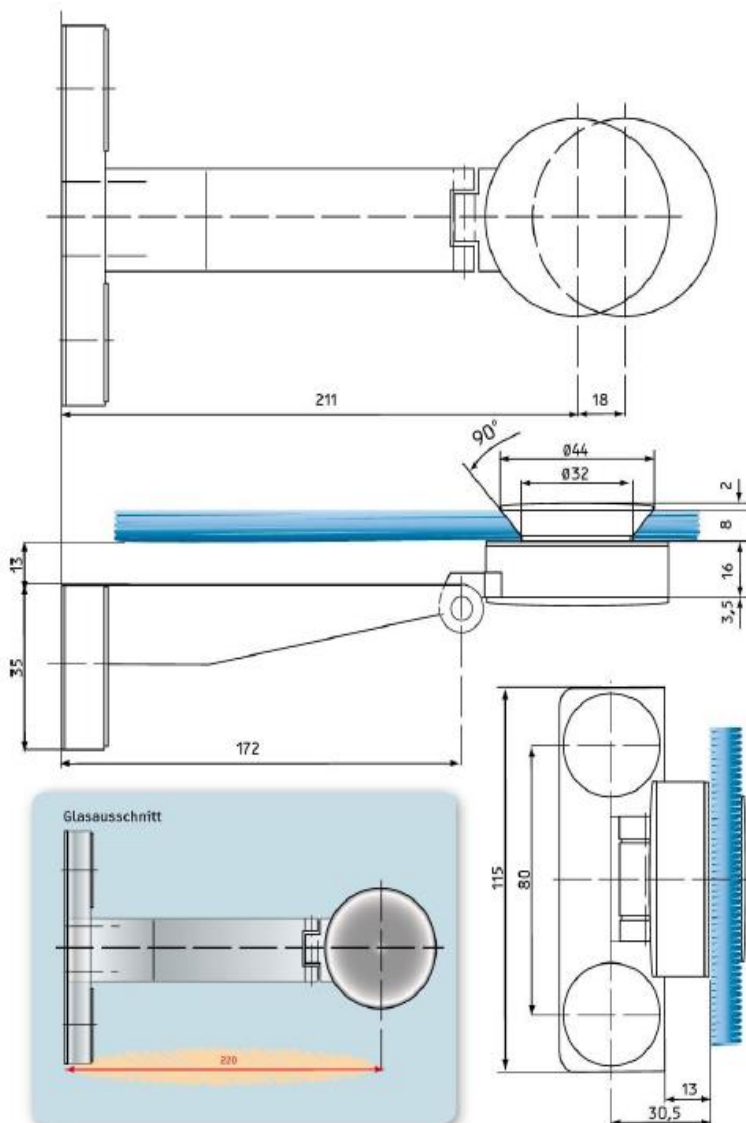

Supporting Arm VarionPlus 195 (screw system)



Useable right and left
 Opening outwards only.

Used glass Type:

ESG 8mm acc.to DIN 1249

Swivel Angle max. 180°

Glass Mounting:

Adjustable from the outside by means of a long hole (+/- 9mm)

Covered adjustable area from inside by means of a cone (+/- 3 mm).

Screw cap as coverage

Wall Mounting:

Adjustable by conical insert ring (+/- 3mm) Covered by a clip-in cap

Mounting Note:

Countersunk screw in stainless steel, Diameter 6mm – 7mm

NewPro – Neue Produkte & innovative Ideen für Oberflächen und Reinigung
Lutz-Henning Robitzsch
Ricarda-Huch-Weg 2 D-40789 Monheim a. Rhein
Tel: +49 (0) 2173/964280 Fax: +49 (0) 2173/964282
eMail: news@newpro.de Internet: www.g-pro.com

**GRAFFITI
MAGIC**



Load Capacity:

Using two brackets max. 50 kg

Glass Pane load,

Maximum door width 110 cm (1 sqm Glass 8mm equates to 20 kg)

Material:

Solid Brass

Surfaces:

Polished chrome and matt chrome.

